

STANDARD type FLANGE type

Ideal for heavy cutting by mounting the angle head flange type directly on the machine spindle surface.

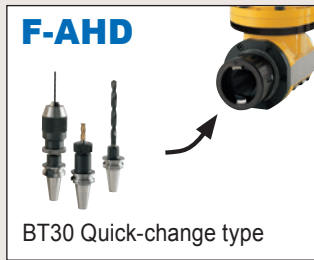

MODEL	Chucking range	Gear ratio		MAX. (min ⁻¹)
		Main spindle : Angle shaft	Main spindle(CCW):Angle shaft(CW)	
AHA20	φ5.8~20	1:0.81		3000:2430
AHA25	φ5.8~25	1:0.96		2500:2400
AHD30	BT30 tools	1:0.96		



Fig. 1

AHA

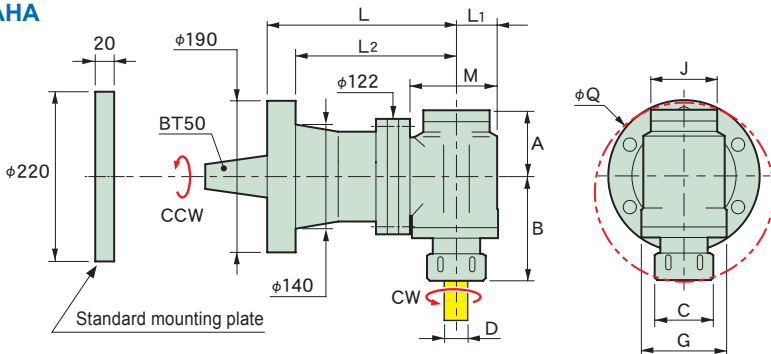
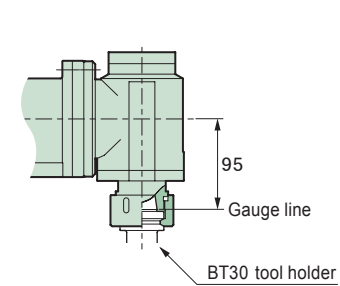

Fig. 2

AHD



CODE	Fig.	φD	L	L ₁	L ₂	M	A	B	G	φC	J	φQ	kg	
F190-AHA20-200	1	5.8~20	200	40	160	92	65	95	88	50	65	171	18	C20
			350		310								28	
-AHA25-200		5.8~25	200	44	160	97	70	110	90	62	70	193	18.5	C25
			350		310								28.5	
-AHD30-200	2	—	200		160					66			19.6	—
			350		310								29.8	

■Option

- Spring collet→P.19
- Retention knob →P.64

■Std. Access.

- A complete set of spanners and wrenches
- Standard mounting plate(No mounting holes are provided.)
- Mounting bolts for ANGLE HEAD

■Note

- NT50U shank is also available.

■Caution

- For mounting plate shapes and mounting bolt location, contact the machine manufacturer or MST.
- The machine spindle and angle shaft should rotate in reverse directions, so make sure the spindle rotates in the reverse direction.
- For precautions and maintenance, refer to page 115.