

TOOL SET UP STATION CLEAN BOX

Tool washing machine

For more information!



Wash the tooling holders, collets, nuts, cutting tools, and small work-pieces thoroughly to maintain their accuracy!

- ▷ Wash tool holders, cutting tools and jig fixtures.
- ▷ No plumbing required.
- ▷ Safe cleaning system using water.
- ▷ Built-in water heater improves washing capability.

CODE
CBX-01

Compact built-in sink

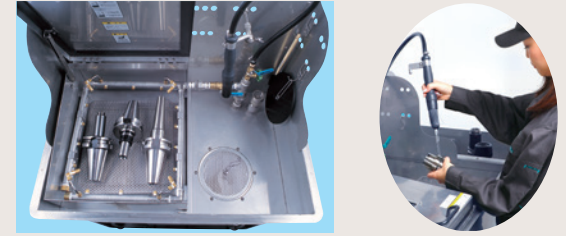

Automatic washing space

Shoots cleaning fluid from 18 location nozzles.

Hand washing space

Heavy dirt can be washed off using the hand nozzle brush and hot water (40°C / 104°F)

Built-in sink with an overflow drain allows pre-soaked washing.

Top cover

Top cover of washing unit can be opened and closed with one hand. Comes with an automatic shutoff function for the washing cycle. Automatic washing stops automatically when the top cover is lifted during operation.

Washing Unit

18 nozzles shoot hot water from every angle to wash off all the dirt.

Timer operating mode

Operation can be stopped automatically using the clock timer. (The time can be set arbitrarily, up to 12 min.)

Light dirt can be washed off using automatic washing.

Heavy dirt can be washed off by hand.



Outer sink cover

Prevents splashing of the washing cleaner.

Hand nozzle

Easy to attach and detach.



Filter

Can be changed easily when it becomes dirty.

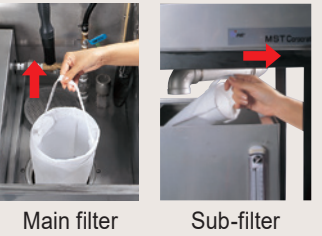

Tank
The use of heated cleaning fluid (40°C) increases the cleaning power and makes cleaning easy even in the winter.



Be sure to use water-soluble cleaning fluid.

The sink, washing unit and tank are made of stainless steel, resulting in easy maintenance and less staining.

Dimensions

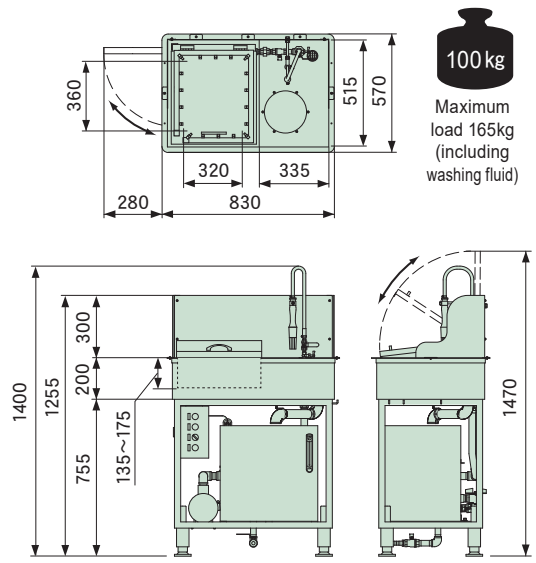

Specification

Material	SU304 (Sink, Tank, Cleaning unit) SS400 (Base frame)
Tank	Approx. 65L (Level gauge with thermometer is standard accessory.)
Pump	0.3~0.51kW (50/60Hz) (Produced by Grundfos)
Heater	3kW (with temperature control)
Weight	Approx. 100kg (165kg, including cleaning fluid)
Voltage	3-phase 200V (Rated 15A)

Std. Access.

CODE	Description	Q'ty
CBX-HNZ	Hand nozzle	1pc.
-MFIL	Main filter	2pcs.
-SFIL	Sub-filter	2pcs.
-TRP	Drain trap	1pc.
-GSTP	Rubber drain plug	1pc.
-WBSK	Washing basket	1pc.
-WTBL	Washing table	1pc.
	Sink outer cover	1set
	Hook	2pcs.
	Bamboo brush	1pc.
	Primary power code (plug attached 15m)	1pc.

Caution
 • Be sure to use water-soluble cleaning fluid.
 • Customers pay the shipping cost.
 • 200V electric power supply (transformer is required)

Option

Draining basket

CODE	Uniformity with stand load 40kg
CBX-SBX	■ Std. Access. • Triple hook

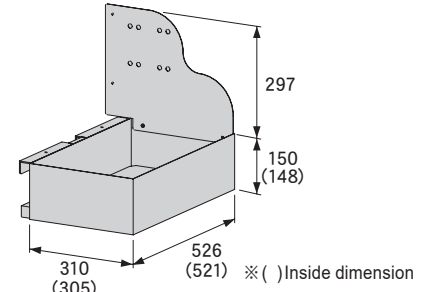
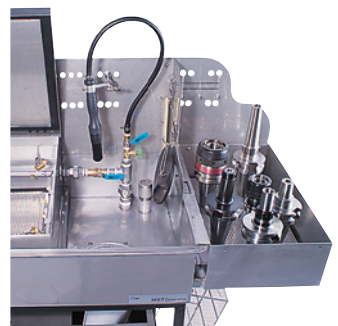

Consumables / Replacement parts

Washing basket

CODE	CBX-WBSK
-------------	----------

Collet and small parts can be washed.



Washing table

CODE	CBX-WTBL
-------------	----------

Used in a sink as an auxiliary table when washing by hand.

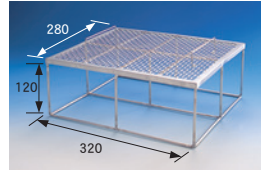

Main filter

CODE	Q'ty
CBX-MFIL	5pcs.



Sub-filter

CODE	Q'ty
CBX-SFIL	3pcs.



Hand nozzle

CODE	CBX-HNZ
-------------	---------



Rubber drain plug

CODE	CBX-GSTP
-------------	----------



Drain trap

CODE	CBX-TRP
-------------	---------



Cleaning fluid

CODE	CBX-EKI
-------------	---------

