

# Hi-ART MILLING CHUCK

Needle-roller type chuck

**The Hi-ART milling chuck achieves the accuracy, rigidity and torque required of a milling chuck. Ideal for use as the end-milling base holder!!**



Shrinker

Thanks to the shrinker, the cutter shank is chucked evenly from the bottom to the top of the gripping range, ensuring high rigidity and gripping force.

coolant-through

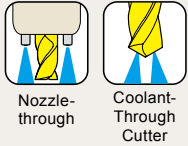

Nozzle-through

Coolant-Through Cutter



**ART**

## The shortest holder length is 85mm (BT40).

The shorter holder length means increased rigidity. The rigidity of the tool holder is inversely proportional to the cube of the length, meaning the deflection of this holder is about half that of a 105mm holder.



## Memory line clearly confirms tightness of the nut.

You can check the recommended degree of tightening at a glance. Also, it only takes about one and half turns for tightening operation.



## Keeps chips and coolant out completely

Dust-proof cover keeps chips and coolant out completely.

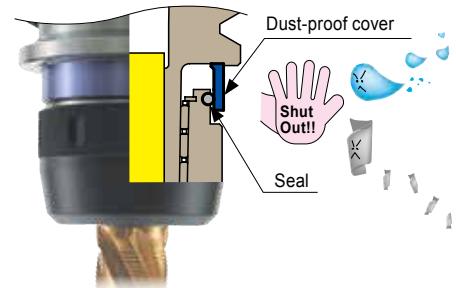

## Applicable for coolant-through version

### Nozzle-through

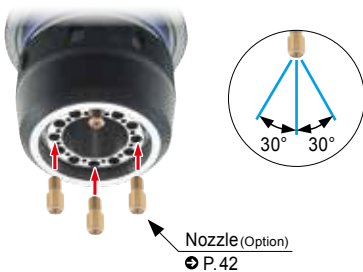

Nozzle (Option)  
P. 42

### Coolant-Through Cutter

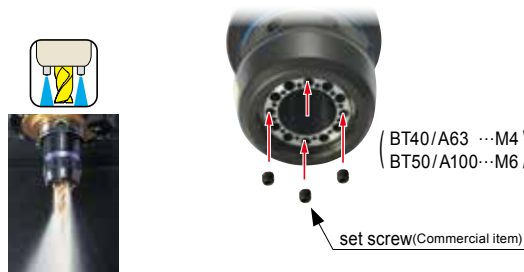

(BT40/A63 ...M4)  
(BT50/A100...M6)

set screw (Commercial item)

Longer cutter life using through-spindle capability → P. 117

## Applicable as a base holder for various applications

